

HUNTERS[®]

HERE TO GET *you* THERE



73 Fairmead

Cam, Dursley, GL11 5JT

Asking Price £200,000



73 Fairmead

Cam, Dursley, GL11 5JT

Asking Price £200,000



COUNCIL TAX BAND - A

ENTRANCE

UPVC framed double glazed front door leading to the entrance hallway with panelled radiator and built-in storage cupboard.

LOUNGE

18'0" x 12'6" (5.49m x 3.81m)

With attractive stone fireplace with gas point, UPVC framed double glazed bay window to the front and two panelled radiators.

KITCHEN

12'2" x 10'6" (3.71m x 3.20m)

With a range of oak effect base units incorporating worktop surfaces with drawers and cupboards under, matching wall storage cupboards and inset single drainer stainless steel sink unit. Cupboard housing Worcester combination boiler supplying central heating and domestic hot water circulation, integrated stainless steel double oven and four ringed gas hob unit, UPVC framed double glazed window with matching door leading to the rear garden, twin panelled radiator, plumbing for an automatic washing machine and vinyl flooring.

BEDROOM ONE

12'5" x 12'0" (3.78m x 3.66m)

With panelled radiator, UPVC framed double glazed window to the front and built-in wardrobe.

BEDROOM TWO

12'0" x 9'9" (3.66m x 2.97m)

With panelled radiator, UPVC framed double glazed window to the rear, shower cubicle with Aqualisa electric shower unit and built-in wardrobe.

BEDROOM THREE

12'0" x 7'9" (3.66m x 2.36m)

With panelled radiator and linen cupboard and access to the roof storage space.

BATHROOM

Having panelled bath, pedestal wash hand basin, panelled radiator and UPVC framed double glazed window to the rear. Separate WC with low level WC, panelled radiator and UPVC framed double glazed window to the rear.

OUTSIDE

There are good sized gardens with the front garden being mainly laid to lawn with mature shrubs, bushes and five bar gated entrance to the long concrete driveway providing parking for several cars and side access leading to the rear gardens which are mainly lawned with summer house, patio and store shed.

- Semi-Detached Pre Fabricated Bungalow
- Spacious Accommodation
- Three Bedrooms
- 18ft Lounge
- Kitchen
- Bathroom & Separate WC
- GCH & UPVC Double Glazing
- Good Sized Gardens & Driveway Parking for Several Cars
- EPC: D

Offering great development this spacious three bedroomed semi-detached pre-fabricated bungalow is located in a popular residential locality in Fairmead, Cam and is offered to cash buyers. This property stands in a good sized plot with generous gardens and driveway parking for several cars. The property is conveniently located within walking distance of Cam village centre with Tesco supermarket, post office and doctors surgery. The property is offered with vacant possession and no upward chain. Keys are held at the Agents office for accompanied viewing.



Road Map



Hybrid Map



Terrain Map

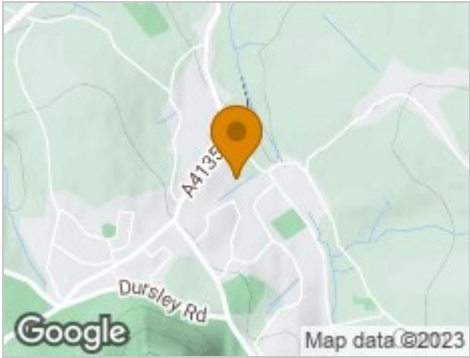

Floor Plan

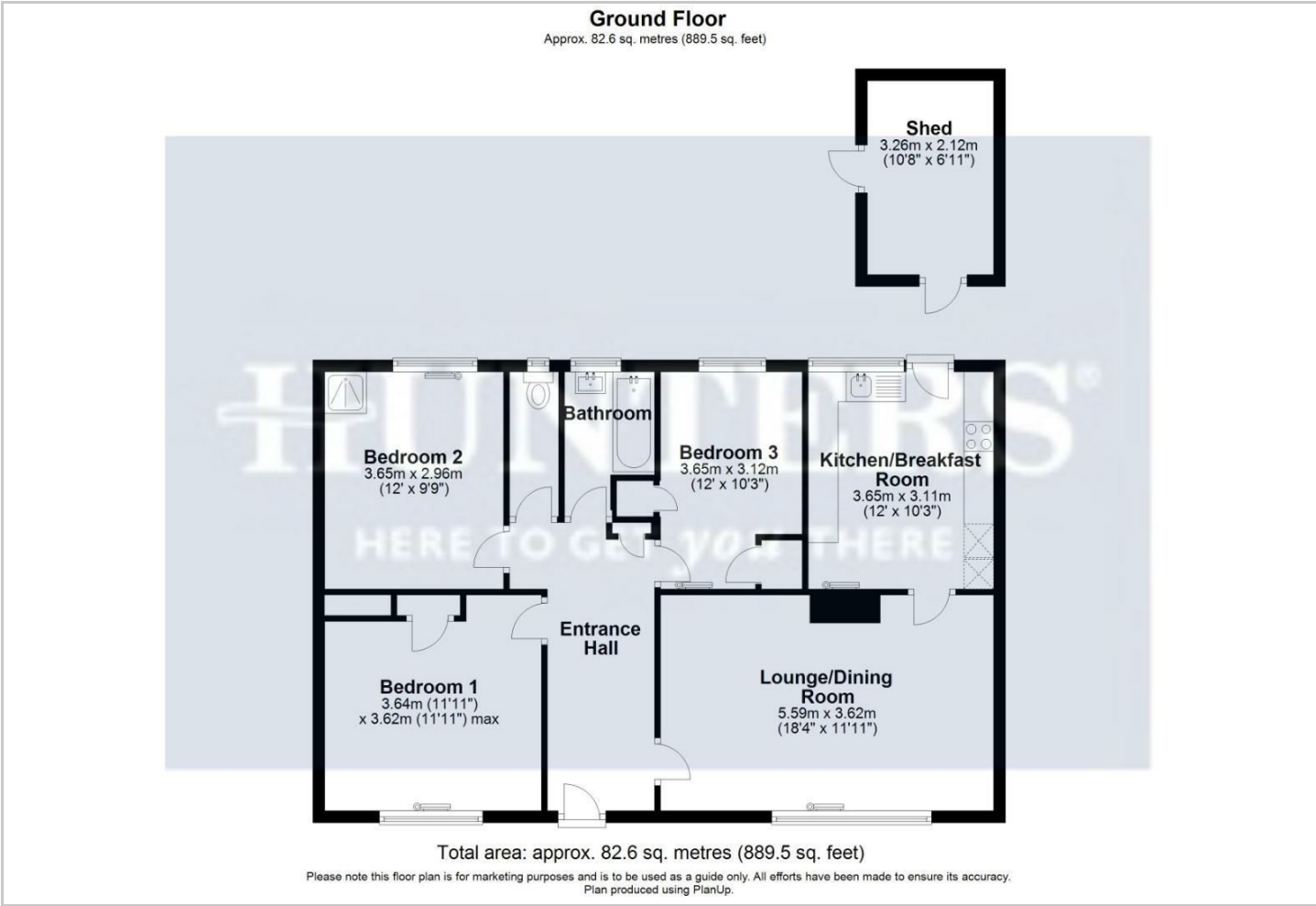

Viewing

Please contact our Hunters Dursley Office on 01453 542 395 if you wish to arrange a viewing appointment for this property or require further information.

Energy Efficiency Graph

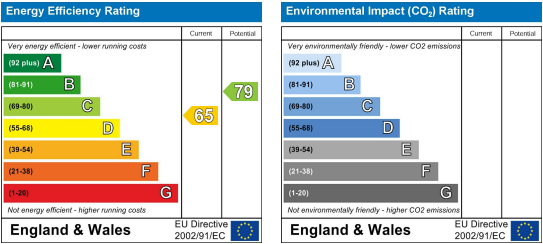

These particulars are intended to give a fair and reliable description of the property but no responsibility for any inaccuracy or error can be accepted and do not constitute an offer or contract. We have not tested any services or appliances (including central heating if fitted) referred to in these particulars and the purchasers are advised to satisfy themselves as to the working order and condition. If a property is unoccupied at any time there may be reconnection charges for any switched off/disconnected or drained services or appliances - All measurements are approximate. **THINKING OF SELLING?** If you are thinking of selling your home or just curious to discover the value of your property, Hunters would be pleased to provide free, no obligation sales and marketing advice. Even if your home is outside the area covered by our local offices we can arrange a Market Appraisal through our national network of Hunters estate agents.